

SECTION A-A
Scale 1'-1'

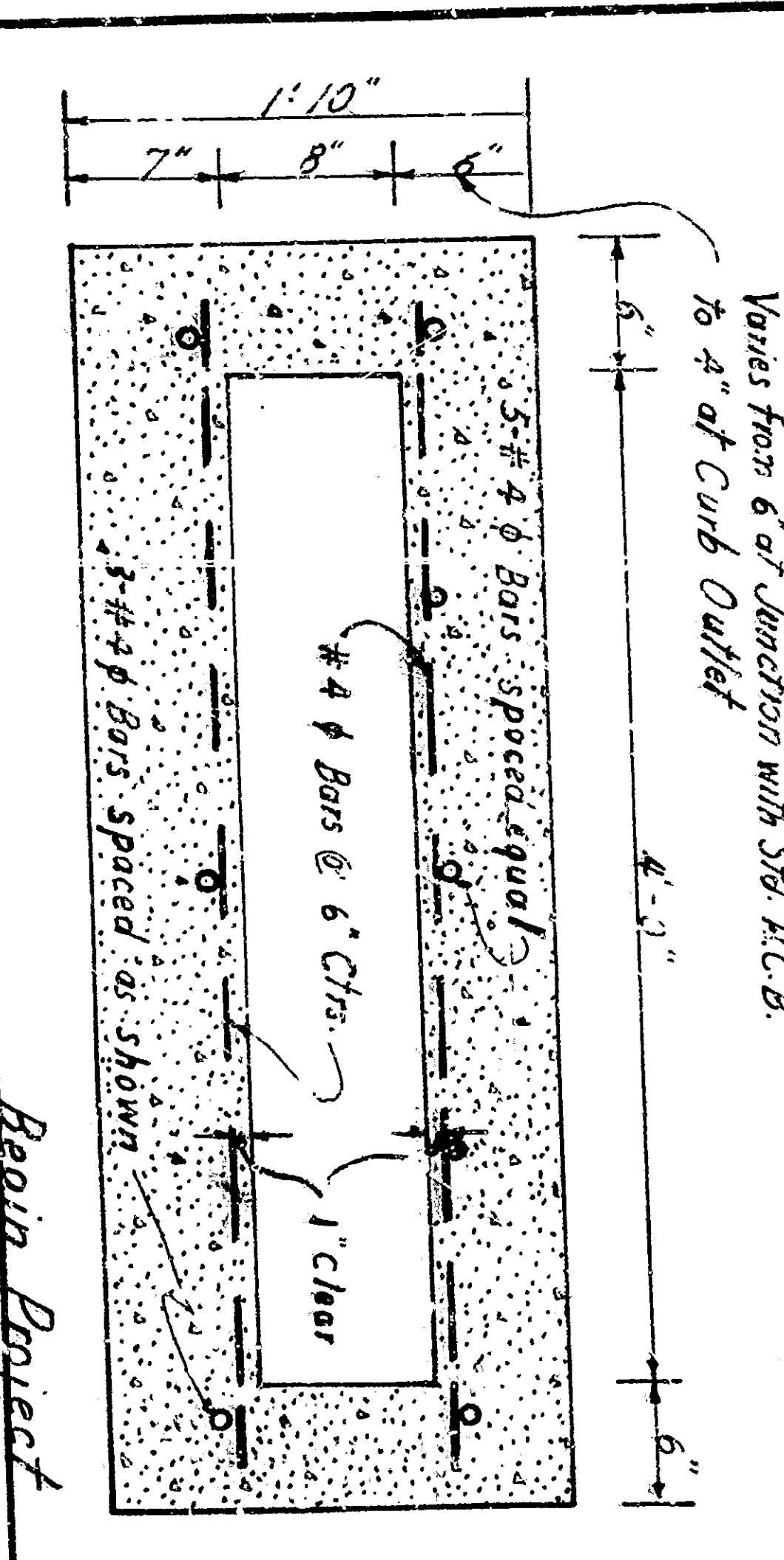

SECTION B-B
Scale 1'-1'

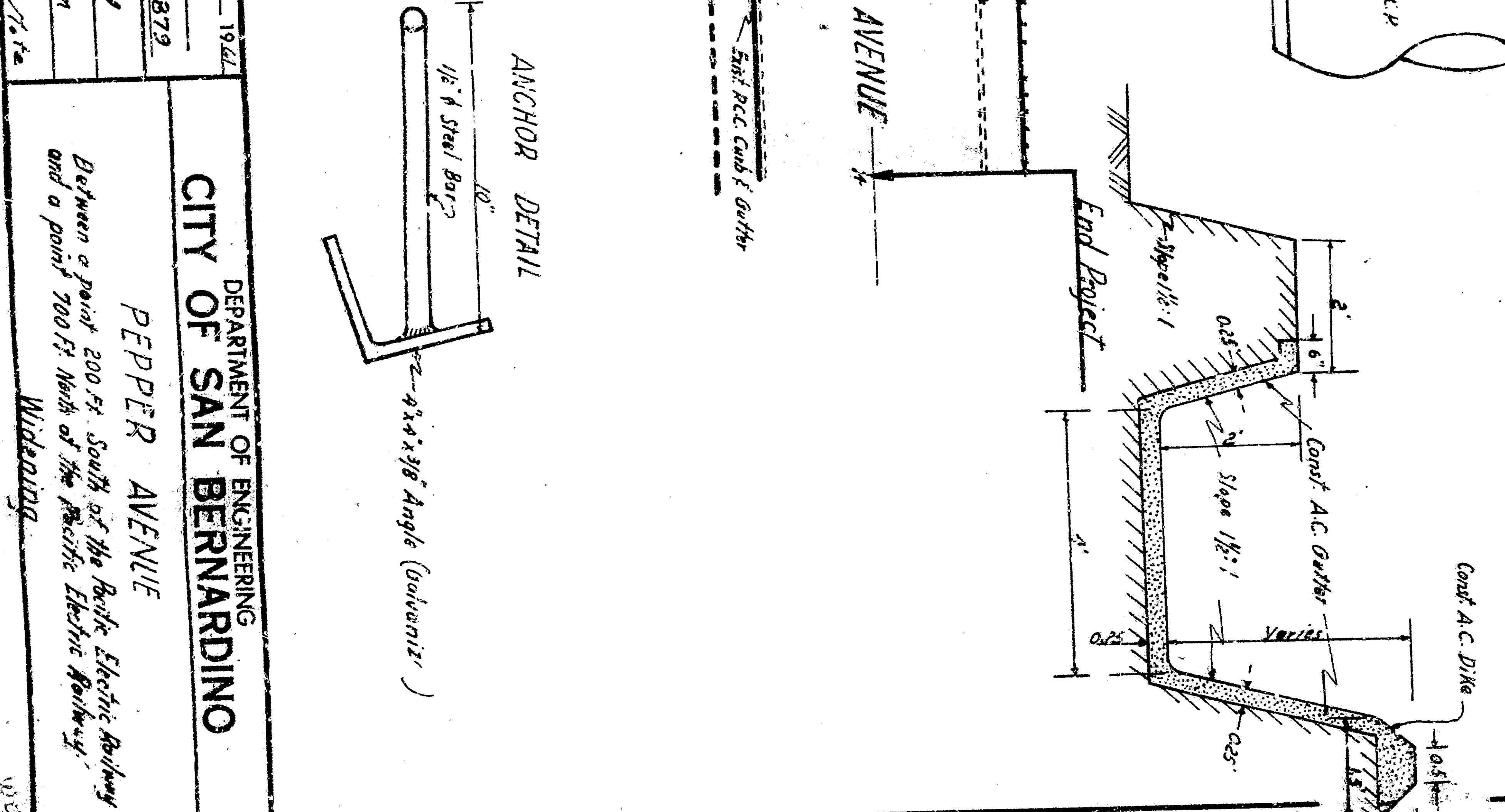
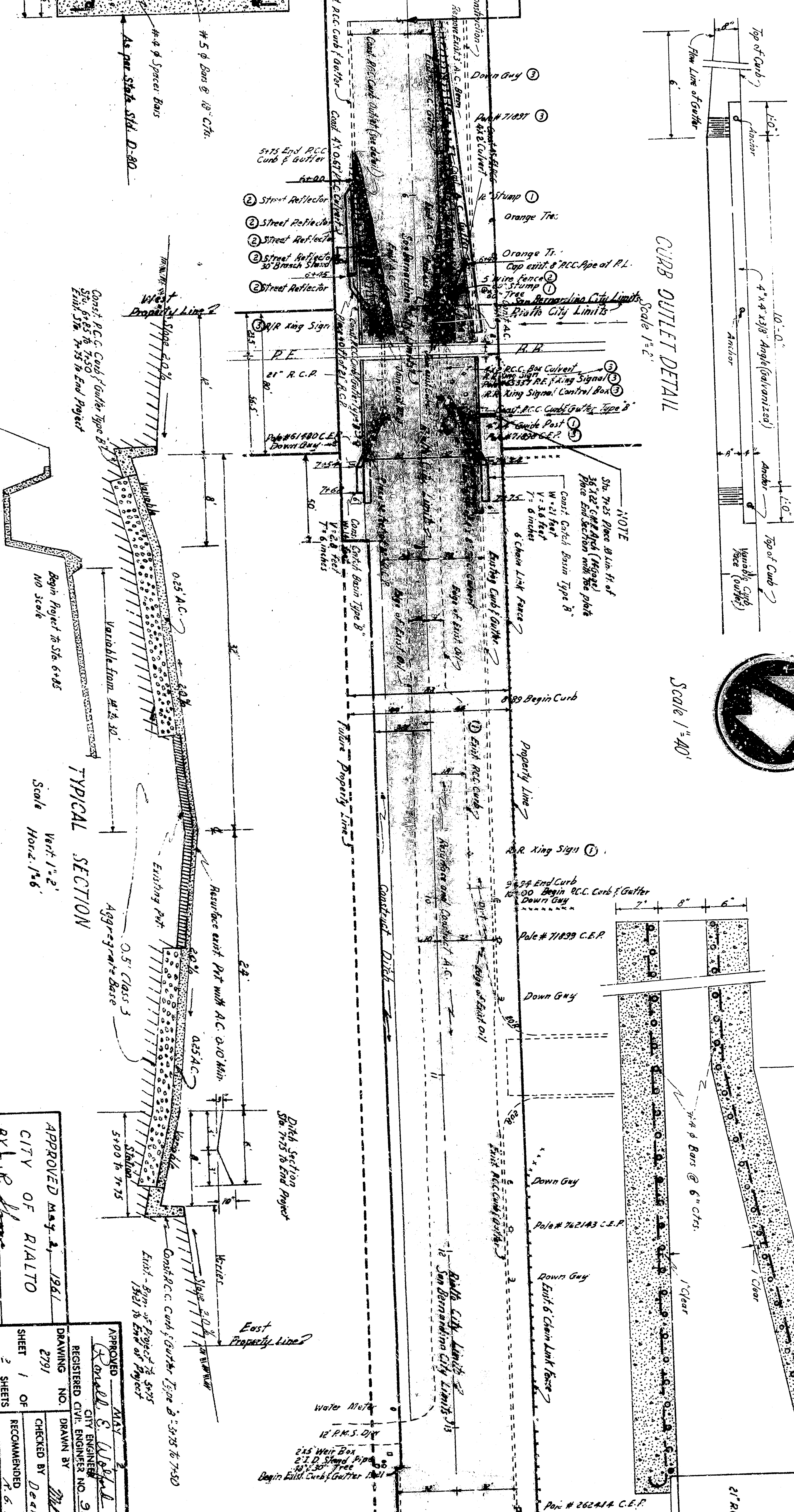

ANCHOR DETAIL
Scale 1'-2'



GENERAL NOTES

1. All work to be done on these plans will be done in conformity with the specifications of the Department of Public Works, Division of Highways, State of California.
2. The contractor shall be responsible for the location of all existing utilities and for the protection of the same.
3. The contractor shall be responsible for the location of all existing structures and for the protection of the same.
4. The contractor shall be responsible for the location of all existing easements and for the protection of the same.
5. The contractor shall be responsible for the location of all existing right-of-way lines and for the protection of the same.
6. The contractor shall be responsible for the location of all existing property lines and for the protection of the same.
7. The contractor shall be responsible for the location of all existing survey monuments and for the protection of the same.
8. The contractor shall be responsible for the location of all existing survey points and for the protection of the same.
9. The contractor shall be responsible for the location of all existing survey lines and for the protection of the same.
10. The contractor shall be responsible for the location of all existing survey corners and for the protection of the same.

APPROVED MAY 4, 1961
CITY OF RIALTO
BY: R. M. ...

REGISTERED CIVIL ENGINEER NO. 9872
DRAWING NO. DRAWN BY 2791
CHECKED BY Decker
SHEETS 1 OF RECOMMENDED 6 & 7/14

DEPARTMENT OF ENGINEERING
CITY OF SAN BERNARDINO
PEPPER AVENUE
Between 200' S. of the Pacific Electric Railway
and a point 700' S. of the Pacific Electric Railway
Widening


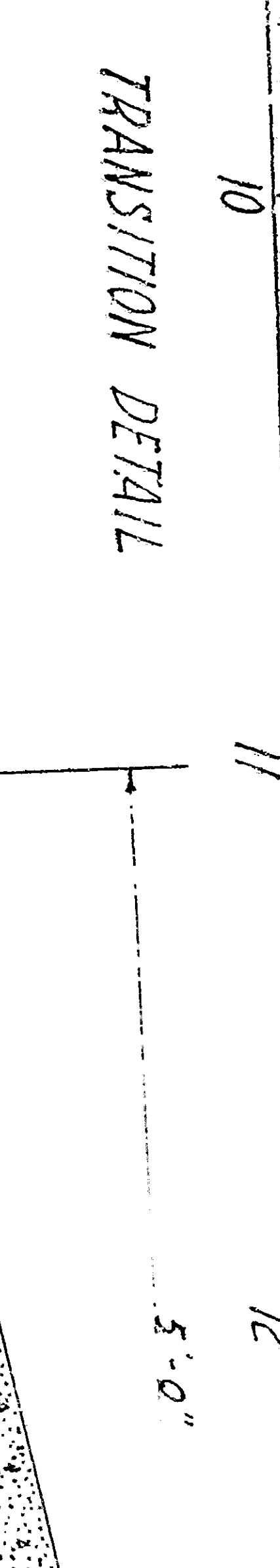
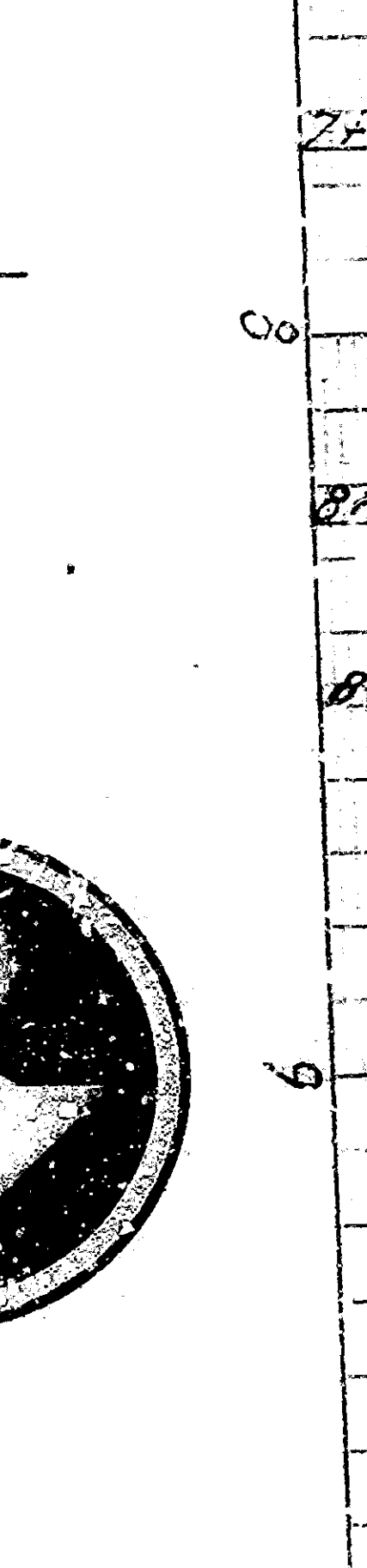
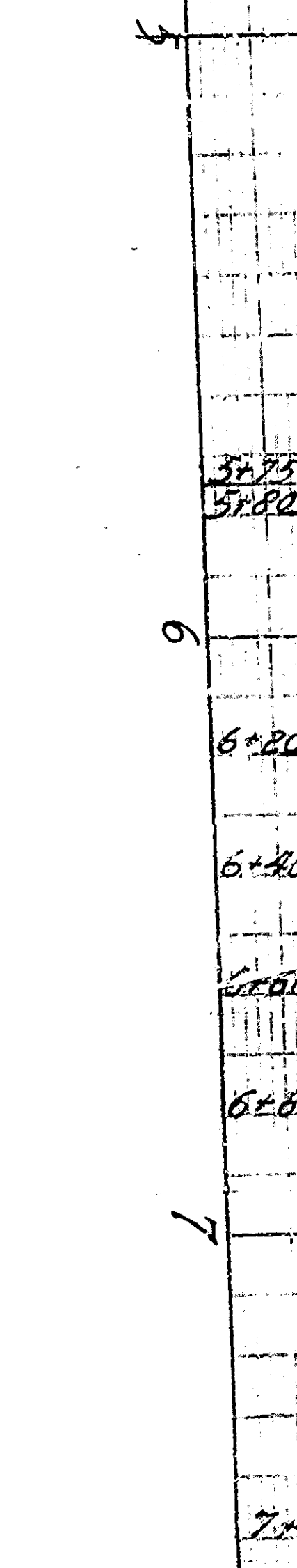
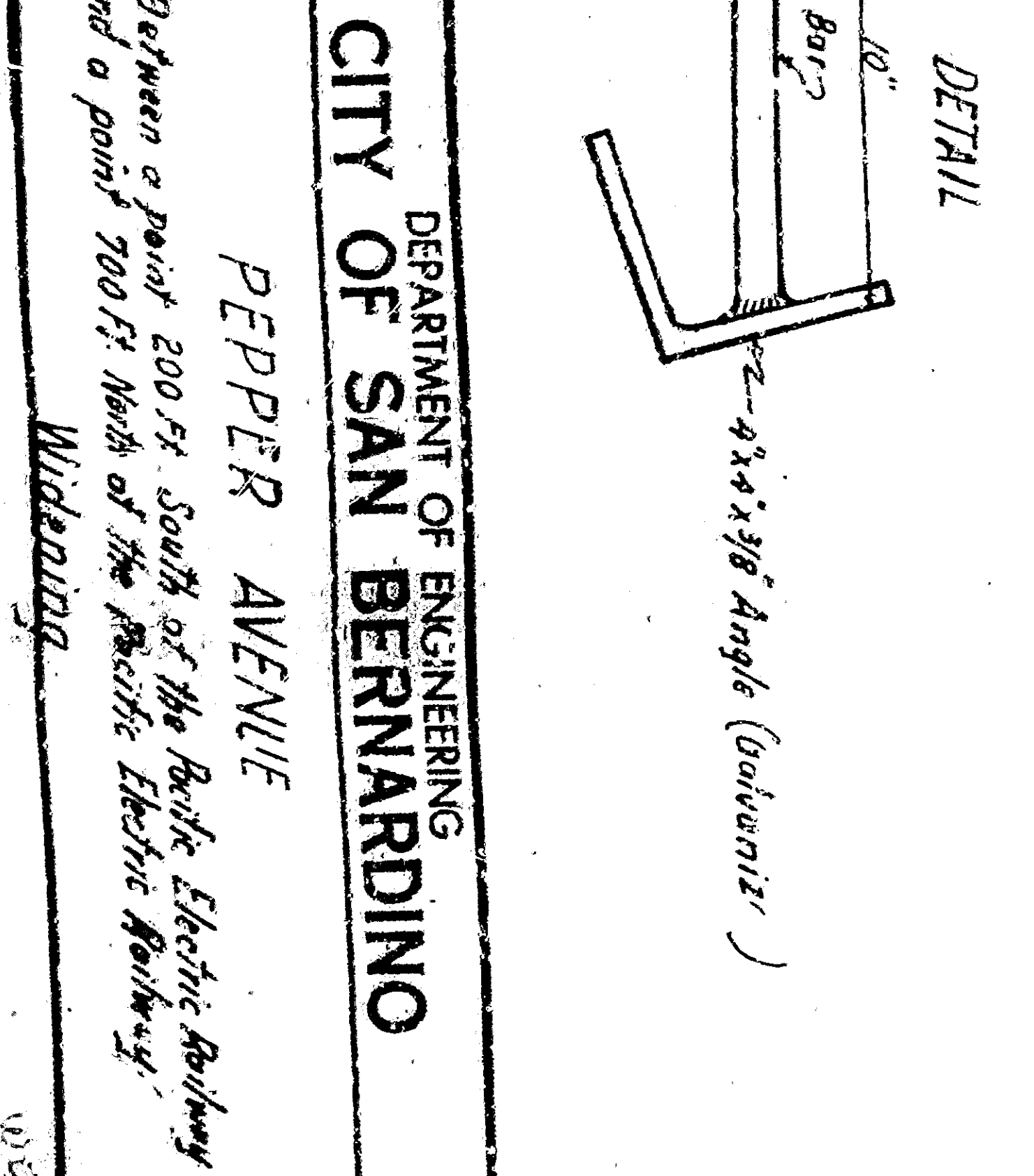
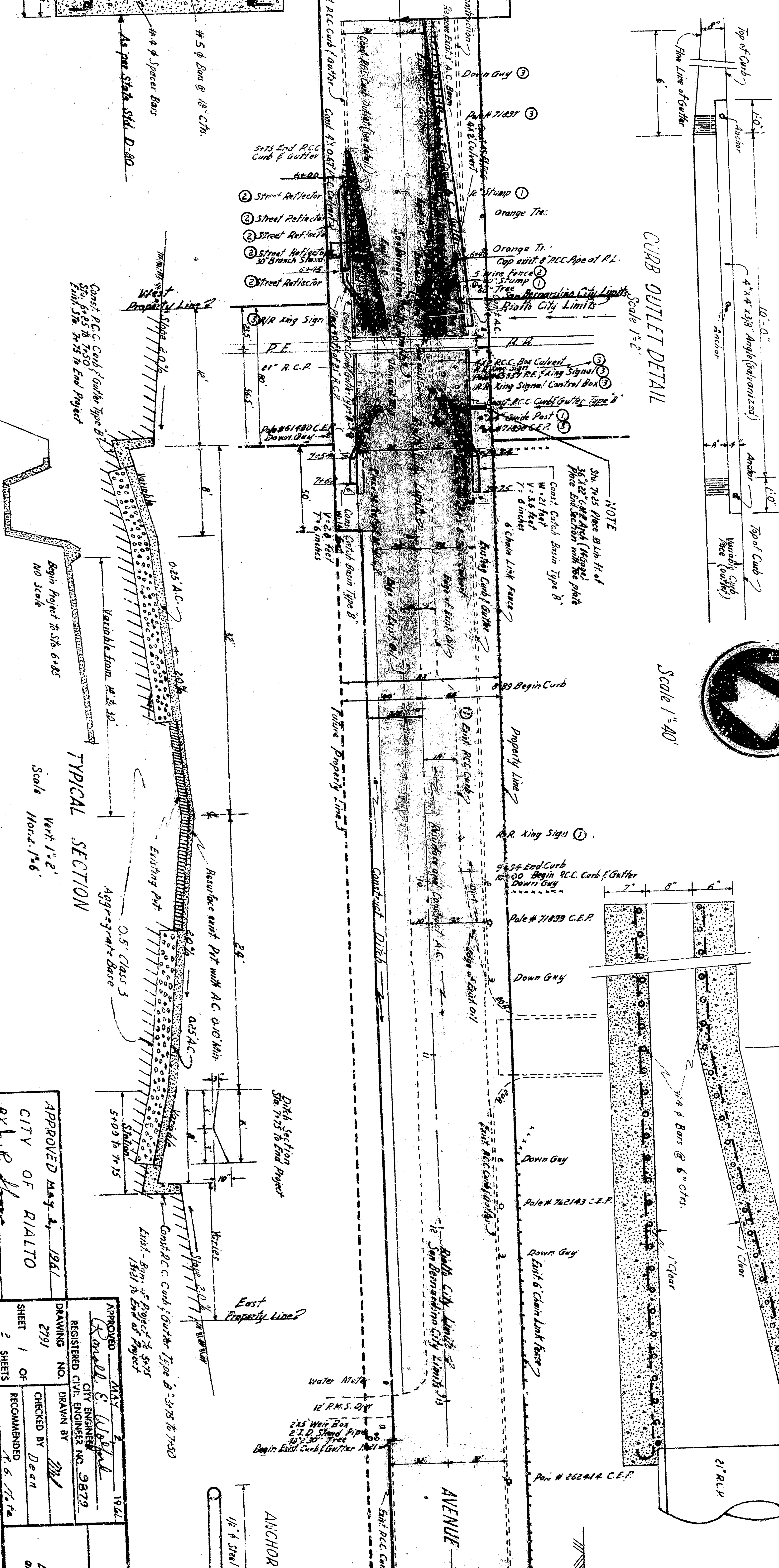
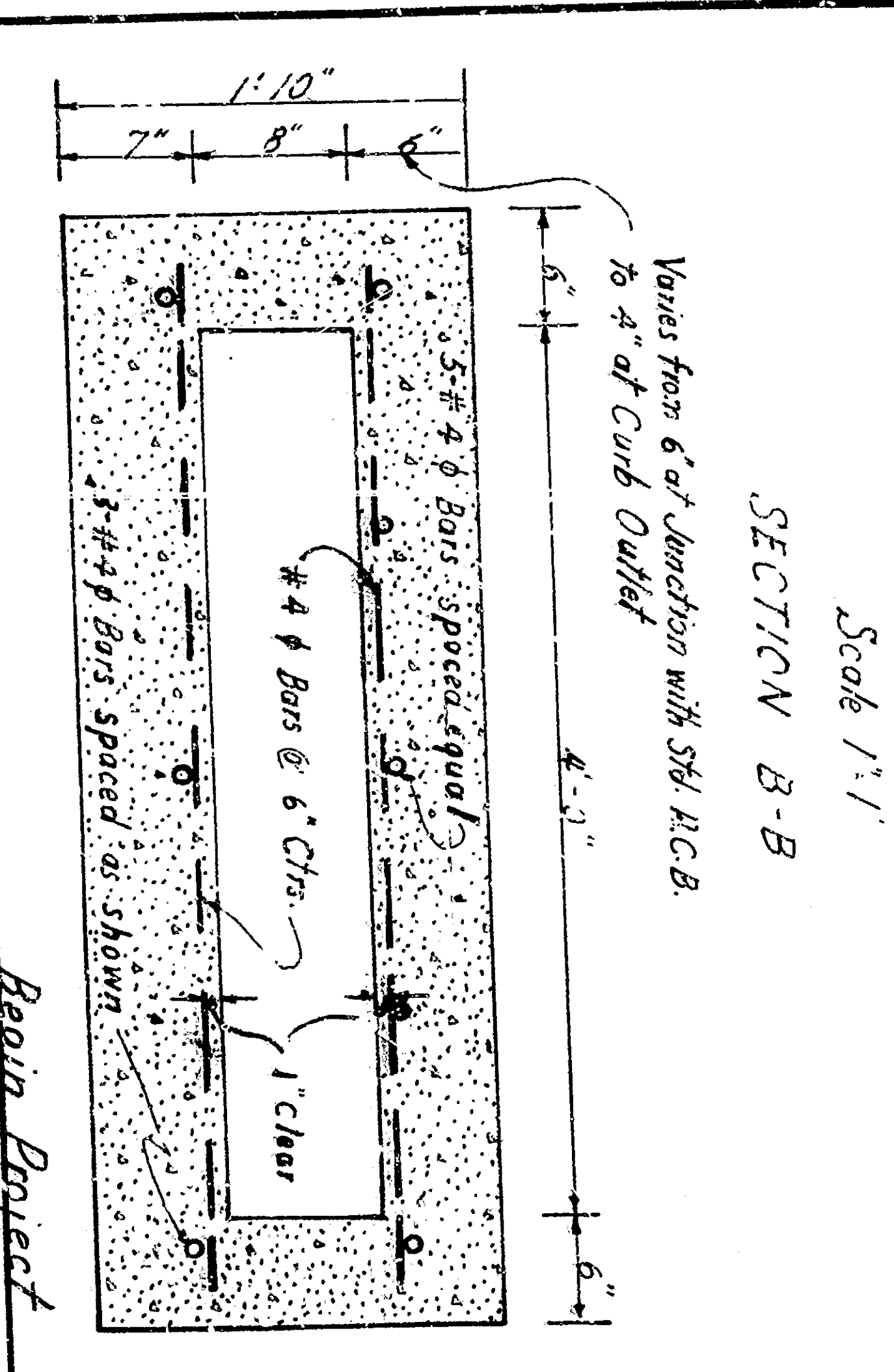
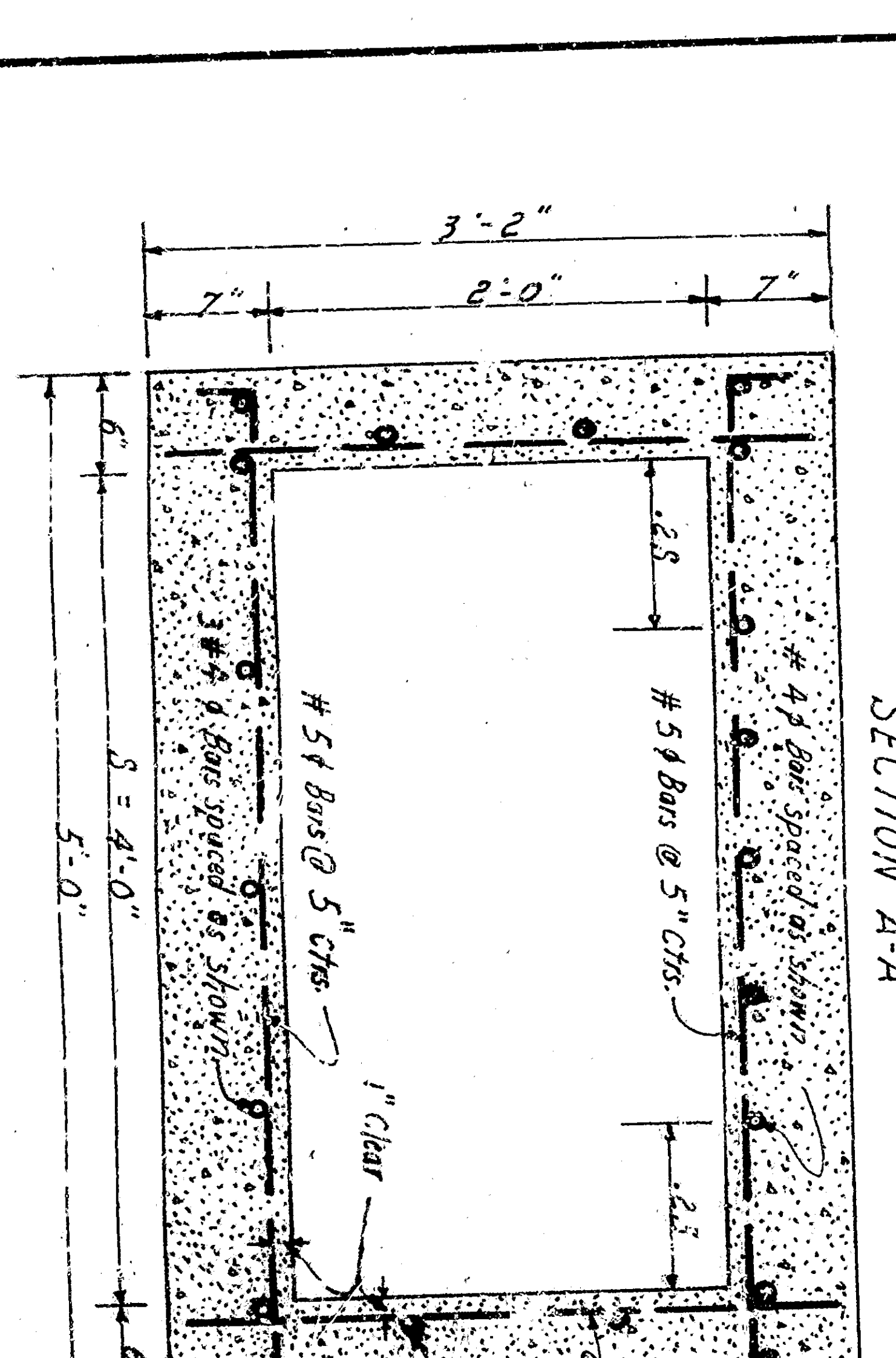

GENERAL NOTES

1. All work to be done on these plans will be done in conformity with the specifications of the Standard Specifications for Highway Construction, Department of Public Works, Division of Highways, State of California.
2. All work to be done on these plans will be done in conformity with the specifications of the Standard Specifications for Highway Construction, Department of Public Works, Division of Highways, State of California.
3. All work to be done on these plans will be done in conformity with the specifications of the Standard Specifications for Highway Construction, Department of Public Works, Division of Highways, State of California.
4. All work to be done on these plans will be done in conformity with the specifications of the Standard Specifications for Highway Construction, Department of Public Works, Division of Highways, State of California.
5. All work to be done on these plans will be done in conformity with the specifications of the Standard Specifications for Highway Construction, Department of Public Works, Division of Highways, State of California.
6. All work to be done on these plans will be done in conformity with the specifications of the Standard Specifications for Highway Construction, Department of Public Works, Division of Highways, State of California.
7. All work to be done on these plans will be done in conformity with the specifications of the Standard Specifications for Highway Construction, Department of Public Works, Division of Highways, State of California.
8. All work to be done on these plans will be done in conformity with the specifications of the Standard Specifications for Highway Construction, Department of Public Works, Division of Highways, State of California.
9. All work to be done on these plans will be done in conformity with the specifications of the Standard Specifications for Highway Construction, Department of Public Works, Division of Highways, State of California.
10. All work to be done on these plans will be done in conformity with the specifications of the Standard Specifications for Highway Construction, Department of Public Works, Division of Highways, State of California.

APPROVED MAY 4, 1961
 CITY OF RIALTO
 BY: R. M. ...

REGISTERED CIVIL ENGINEER NO. 9872
 DRAWING NO. DRAWN BY 2791
 CHECKED BY Decker
 SHEET 1 OF RECOMMENDED 2 SHEETS

DEPARTMENT OF ENGINEERING
 CITY OF SAN BERNARDINO
 PEPPER AVENUE
 Between a point 200' S. of the Pacific Electric Railway and a point 700' S. of the Pacific Electric Railway.
 Widening